

**Pilot's Operating Handbook and
FAA Approved Airplane Flight Manual
Supplement
Winterization Kit**

When the Winterization Kit Inlet covers are installed in accordance with SB2X-71-04, this POH Supplement is applicable and must be inserted in the Supplements Section (Section 9) of the Cirrus Design SR22 Pilot's Operating Handbook. This document must be carried in the airplane at all times. Information in this supplement adds to, supersedes, or deletes information in the basic SR22 Pilot's Operating Handbook.

• Note •

This POH Supplement Revision dated Aug 22, 2017 supersedes and replaces Revision 01 of this supplement dated Dec 07 2004.

FAA Approved

for Bruce D. Remick, Manager
Flight Test Branch
Federal Aviation Administration

Aug 22, 2017
Date

Section 1 - General

This airplane is equipped with removable cowl inlet airflow restrictors. Figure 1 shows installation instructions.

Section 2 - Limitations

Winterization Kit

1. The airplane must not be operated above 32°F when the Winterization Kit cowl inlet covers (airflow restrictors) are installed.

Placards

On forward side of each Cowl Inlet Cover:

**REMOVE WHEN
OUTSIDE TEMP
IS ABOVE 32° F**

On aft side of each Cowl Inlet Cover:

Serials 0002 through 0794 and Serials 0796 through 0819:

**NOT FOR USE ON A/C
W/ LANDING LIGHT
IN COWL INLET**

Section 3 - Emergency Procedures

No Change.

Section 4 - Normal Procedures

Install Cowl Inlet Airflow Restrictor (See Figure 1)

1. Loosen screw securing latch plate to inlet cover and slide latch plate inboard.
2. Position inlet cover in inlet.
3. Slide latch plate outward (behind edge of cowl) and tighten screw.
4. Install inboard screw securing inlet cover to cowl.
5. Repeat procedure for opposite cowl inlet cover.

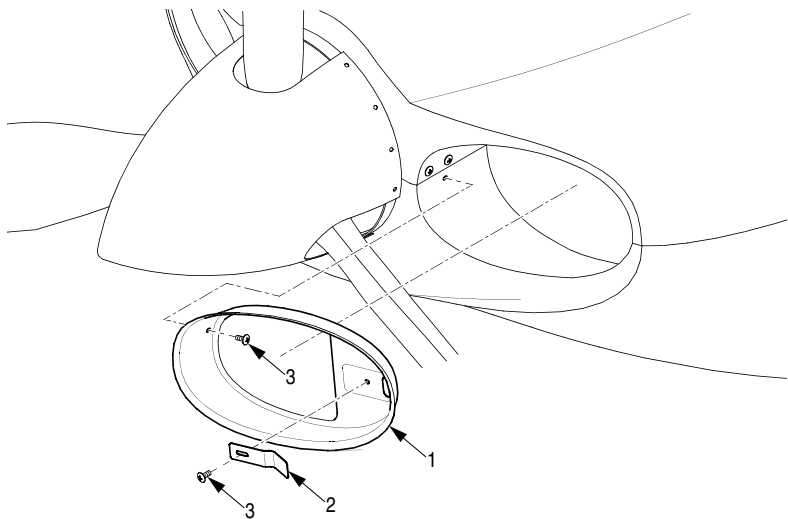

Serials 0002 through 0794 and 0796 through 0819.

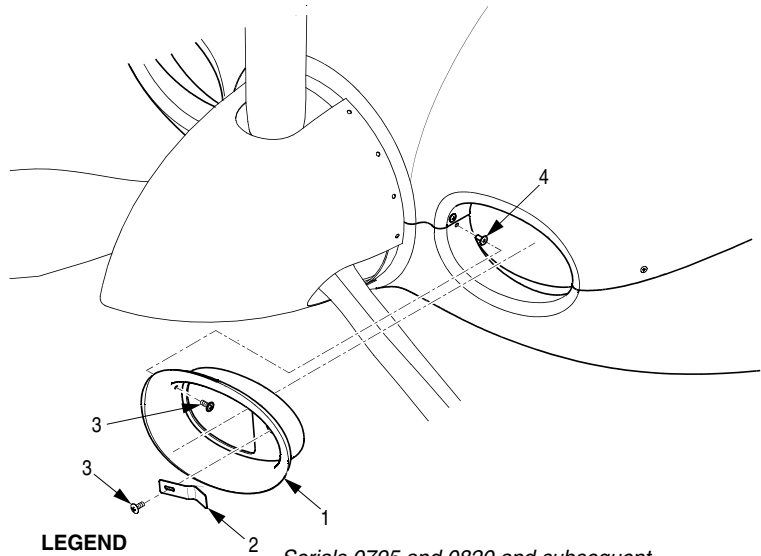

LEGEND

- 1. Cowl Inlet Cover
- 2. Latch Plate
- 3. Screw
- 4. Wellnut

Serials 0795 and 0820 and subsequent.

SR22_FM09_1516B

Figure - 1
Cowl Inlet Installation

Section 5 - Performance

No Change.

Section 6 - Weight & Balance

Change is Negligible.

Section 7 - Systems Description

• Caution •

Use of the inlet cover airflow restrictors above 32° F (0° C) ambient temperature may result in CHT and Oil Temperatures above the red line.

The Winterization Kit consists of two cowl inlet covers that can be easily installed in the inlets to restrict airflow into the engine compartment. When the ambient temperature is below 32° F (0° C), installing the inlet covers allows the engine to reach and maintain CHT (Cylinder Head Temperatures) and Oil Temperatures well into the green arc. The covers are easily installed and removed using only a screwdriver.

Intentionally Left Blank