

**Pilot's Operating Handbook and  
FAA Approved Airplane Flight Manual  
Supplement**

# **Winterization Kit**

When the Winterization Kit Inlet covers are installed in accordance with SB2X-71-04 this POH Supplement is applicable and must be inserted in the Supplements Section (Section 9) of the Cirrus Design SR20 Pilot's Operating Handbook. This document must be carried in the airplane at all times. Information in this supplement adds to, supersedes, or deletes information in the basic SR20 Pilot's Operating Handbook.

• Note •

This POH Supplement Revision dated Jul 27, 2018 supersedes and replaces Revision 1 of this supplement dated Dec 07, 2004.

FAA Approved  <sup>Jul 27, 2018</sup>  
Date \_\_\_\_\_  
Manager, Southwest Flight Test Section, AIR-713  
Federal Aviation Administration  
Ft. Worth, TX

## **Section 1 - General**

This airplane is equipped with removable cowl inlet airflow restrictors. Figure 1 shows installation instructions.

## **Section 2 - Limitations**

### **Winterization Kit**

1. The airplane must not be operated above 32°F when the Winterization Kit cowl inlet covers (airflow restrictors) are installed.

### **Placards**

***On forward side of each Cowl Inlet Cover:***

**REMOVE WHEN  
OUTSIDE TEMP  
IS ABOVE 32° F**

***On aft side of each Cowl Inlet Cover:***

*Serials 1005 through 1147 before Service Bulletin SB20-71-03:*

**FOR USE ON A/C  
W/ LANDING LIGHT  
IN COWL INLET**

*Serials 1148 through 1422 and Serials 1005 through 1147 after Service Bulletin SB20-71-03:*

**NOT FOR USE ON A/C  
W/ LANDING LIGHT  
IN COWL INLET**

## **Section 3 - Emergency Procedures**

No Change.

## **Section 4 - Normal Procedures**

### **Install Cowl Inlet Airflow Restrictor (See Figure 1)**

1. Loosen screw securing latch plate to inlet cover and slide latch plate inboard.
2. Position inlet cover in inlet.
3. Slide latch plate outward (behind edge of cowl) and tighten screw.
4. Install inboard screw securing inlet cover to cowl.
5. Repeat procedure for opposite cowl inlet cover.

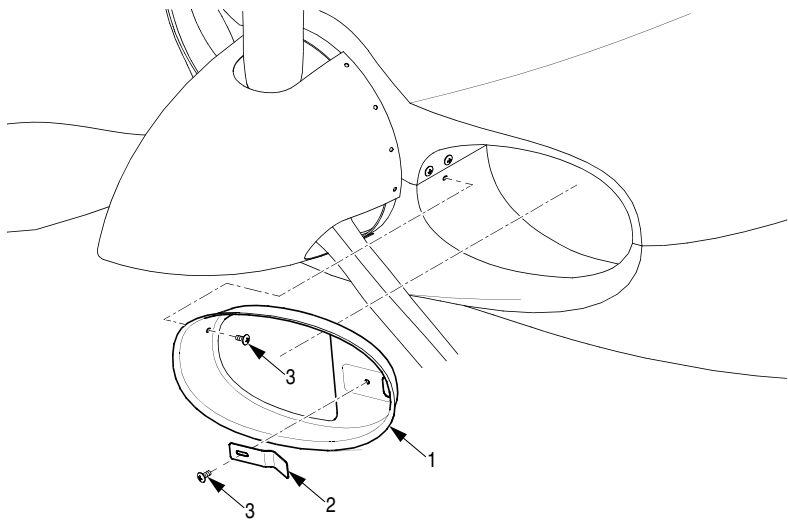

*Serials 1005 through 1422.*

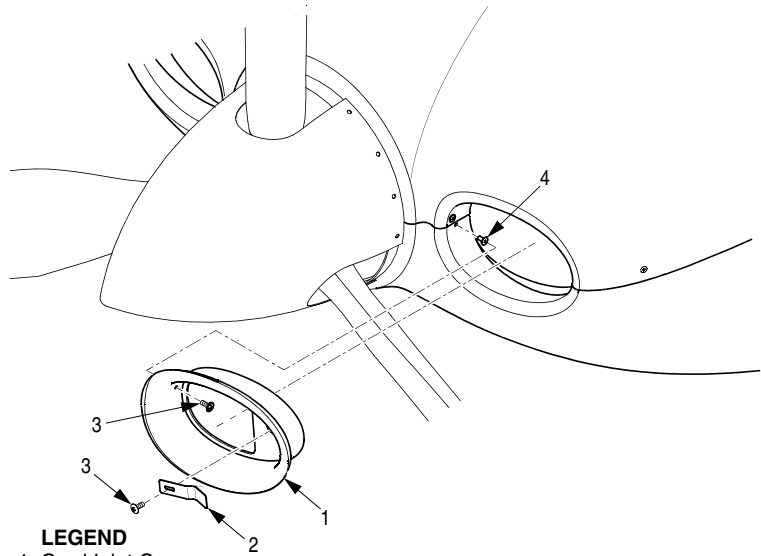

**LEGEND**

- 1. Cowl Inlet Cover
- 2. Latch Plate
- 3. Screw
- 4. Wellnut

*Serials 1423 and subsequent.*

SR20\_FM09\_1516B

**Figure - 1**  
**Cowl Inlet Installation**

## Section 5 - Performance

No Change.

## Section 6 - Weight & Balance

Change is Negligible.

## Section 7 - Systems Description

### • Caution •

Use of the inlet cover airflow restrictors above 32° F (0° C) ambient temperature may result in CHT and Oil Temperatures above the red line.

The Winterization Kit consists of two cowl inlet covers that can be easily installed in the inlets to restrict airflow into the engine compartment. When the ambient temperature is below 32° F (0° C), installing the inlet covers allows the engine to reach and maintain CHT (Cylinder Head Temperatures) and Oil Temperatures well into the green arc. The covers are easily installed and removed using only a screwdriver.

Intentionally Left Blank